



INSTALLATION INSTRUCTIONS

Tech Support
856-768-5700 EXT 2
TechSupport@LEDGlow.com

Million Color Mini SMD Interior Lighting Kit

Warning: This kit is for off road use only. Please check your state and local laws before installing this Interior Lighting Kit. Every state has different policies and procedures in place regarding aftermarket LED lighting accessories. LEDGlow is not responsible for any fines that you may receive while using this lighting kit.

Warning: The installation of this kit is recommended to be performed by a licensed professional. The improper installation of this kit will void all warranties.

The control box must be installed in a dry location! Having this part exposed to water or the elements will cause the kit to fail. Any water damage or corrosion to this part will void all warranties.

PLEASE READ THE FOLLOWING INSTRUCTIONS THOROUGHLY BEFORE INSTALLING AND OPERATING THIS INTERIOR LIGHTING KIT.

Million Color Mini SMD Interior Lighting Kit Includes:

- 4" Flexible Interior Tubes
- (1) Control Box
- (1) Wireless Remote
- (6) Mini USB Cables
- 3M™ Tape

Million Color Mini SMD Interior Lighting Kit Installation:

1. **Warning:** Do not turn on or connect power to the control box until all of the cables and tubes are properly connected.
2. Arrange the tubes the way you plan to install them on the interior of the vehicle and test the kit to ensure it is functioning properly before installing.
3. Each interior tube can be mounted virtually anywhere in the vehicle. Our recommended locations are under the dashboard facing the footwell area, under the driver and passenger seats facing the footwell area, under the back of the driver and passenger seats facing the back seats or even in the trunk.
4. **Optional:** Remove any trim pieces from the interior of the vehicle that may hinder the installation of the interior tubes.
5. Starting with the front tubes, mount them with plenty of clearance from any moving part such as the steering shaft and pedals. Repeat this step with the remaining tubes.
6. Now that the tubes are installed, you can now run the mini USB cables to each tube. Each tube daisy chains to the next tube in the sequence for a quick and easy installation. Output A and Output B located on the side of the control box are used to power the LED interior tubes. You can use either one or both of the outputs but do not need to make a circuit from Output A to Output B. Make sure the cables are not close to the seat tracks or anything else that may potentially cut or pinch the cables.
7. Find a safe, secure and dry location to mount the control box. We recommend mounting the control box in your center console, under the seat, under the dashboard or in your glove box.
8. You can power this kit by running the power and ground wires directly to the battery, connecting it to the fuse panel using LEDGlow's Expandable Circuit or by using LEDGlow's Cigarette Lighter Adapter, which are available at www.LEDUnderbody.com.
 - If you are running the power and ground wires to the battery and going through the firewall or any other metal parts, you must protect the wires by using an existing grommet or by drilling a new hole in the firewall and adding a new grommet. If you need to extend the wires, be sure to use 16 or 18 gauge automotive grade wiring and re-install a fuse within 6 inches of the power source. (Fuse not included if you extend the wires.) The red power wire connects to the positive (+) terminal and the black ground wire connects to the negative (-) terminal of the battery.
 - If you are powering your interior kit using LEDGlow's Expandable Circuit, be sure to power the kit from any 5-10 amp fuse. Remove the stock fuse from the fuse panel and insert into the empty slot of the expandable circuit, next to the

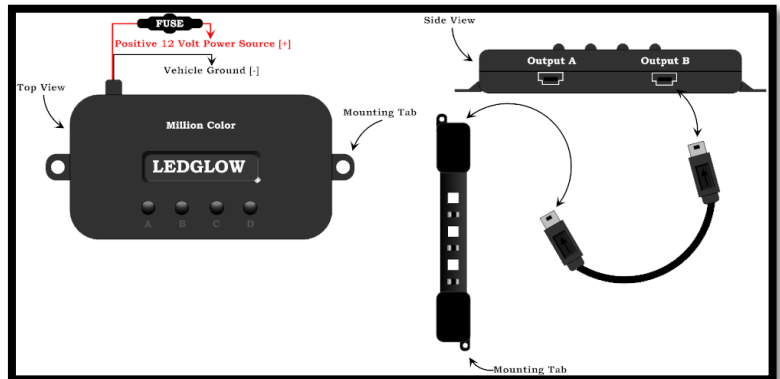

INSTALLATION INSTRUCTIONS



Tech Support
856-768-5700 EXT 2
TechSupport@LEDGlow.com

included 4 amp fuse. Next, crimp the red power wire to the blue butt connector of the expandable circuit and insert the circuit into the empty fuse slot. Connect the black ground wire to an unpainted, bare metal ground source.

- If you are powering your interior kit using LEDGlow's Cigarette Lighter Adapter, simply place the red wire into one of the open connectors and crimp the connector to secure the wire. Next, place the black negative wire into the remaining open connector and crimp the connector to secure the wire. Finally, connect the connector with the red wire to the positive wire on the adapter and the black wire to the negative wire on the adapter.
9. If you removed any interior trim pieces for the installation, you can now reinstall those pieces and test the functionality of the kit once more.

Auto Illumination Function with a Switched Source:

This interior lighting kit has the ability to be powered ON and OFF with a switched power source, such as the ignition, door switch, or headlights. This will allow the kit to automatically turn on when this specific circuit is powered, and allow the system to automatically turn off when this circuit is unpowered. To enable this function, turn the light kit OFF. Press and hold down buttons B and C on the control box simultaneously for 5-10 seconds. The LEDs on the tubes will flash the green color once to show that this function has been enabled. The kit will now turn on as soon as the control box receives power. To disable this function, turn the light kit OFF. Press and hold down buttons B and D on the control box simultaneously for 5-10 seconds. The LEDs on the tubes will flash the red color once to show that this function has been disabled.

Controller Operation:

Button A: Powers the interior kit on and off. (Press and hold for 3 seconds.)

- During operation, press the button once to pause the current color changing pattern. Press it a second time to resume the color changing pattern.

Button B: Mode Selection

- Million Color Cycle Mode
- Million Color Fade Mode
- 18 Color Changing Mode
- SOS Flashing Mode
- Solid Illumination Mode
- Single Color Flashing Mode
- 18 Color Flashing Mode
- Demo Mode (Cycles through all modes every 15 seconds.)

Button C: Color Selection

- Blue
- Red
- Pink
- Purple
- Teal
- Light Yellow
- Bright White
- Warm White
- Orange
- Violet
- Deep Blue
- Hot Pink
- Green
- Yellow
- Ice Blue
- Lime Green
- Light Purple
- Dark Purple

Button D: Speed Function / Music Mode

- There are 5 speed levels available.
- **Music Mode:** Lights flash to the music playing inside of your vehicle.
 - Press and hold the button for 3 seconds to activate the music mode. (You will hear one beep when music mode is activated.)
 - Press and hold the button for 3 seconds to deactivate music mode. (You will hear two beeps when music mode is deactivated.)

Expandability Options: This 6pc Million Color Mini SMD Interior Lighting Kit can be expanded to power a total of (24) 4" flexible tubes (72 SMD LEDs).

Reprogramming the Wireless Remote: Turn the kit off. Press and hold any button the wireless remote. While holding the button down, press the B button on the control box. If the sync was successful you will hear one beep. If the sync was unsuccessful you will hear multiple beeps. If the sync was unsuccessful, repeat the steps and if you are still having problems, please contact our Technical Support Department at 877-LED-GLOW.

For accessories, replacement parts and/or technical assistance, please visit www.LEDUnderbody.com for more information.

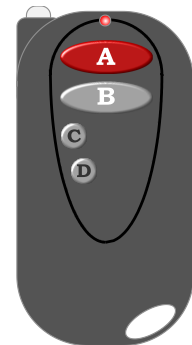



INSTALLATION INSTRUCTIONS

Tech Support
856-768-5700 EXT 2
TechSupport@LEDGlow.com

ONE YEAR NON-TRANSFERRABLE LIMITED WARRANTY AND DISCLAIMER

LEDGlow Lighting, LLC ("LEDGlow") warrants to the original retail consumer purchaser, and not any other purchaser or subsequent owner, that this Product will be free from defects in material or workmanship for a period of **one (1) year** from the purchase date. **This warranty does not cover any Product that is (1) installed incorrectly, or (2) damaged by collisions, vandalism, other accidents, or similar causes.**

For a period of **one (1) year** from the date of purchase, at no charge to the Purchaser, LEDGlow will repair or replace this Product if it is determined by LEDGlow to be defective. After the warranty period, the Purchaser must pay all charges for parts and labor.

Coverage under this warranty is only valid within the United States, including its territories, as well as in certain other countries. Purchasers should check our website, www.LEDGlow.com, to determine the warranty coverage in the countries in which they are located.

LEDGlow does **not warrant the installation** of the Product, which is the sole responsibility of the Purchaser. Installation should be done by licensed professionals. Improper installation may cause damage to the Product and any vehicle in which it is installed, and may cause burns and electrical injury to individuals. LEDGlow's warranty does not cover any expenses incurred in removing Products that are defective or re-installing replacement Products in their place.

During the warranty period, to have the Product repaired or replaced, the Purchaser must return the Product, freight prepaid by the Purchaser, to LEDGlow (but for customers in the contiguous United States, LEDGlow will pay the shipping charges if any Product fails during the first thirty (30) days after purchase). The Product must be returned in its original carton or in a similar package affording an equal degree of protection. LEDGlow will return the repaired or replaced Product, freight prepaid, to the Purchaser. LEDGlow does not provide Purchasers with temporary replacement units during the warranty period or at any other time.

This limited warranty is non-transferrable and will automatically terminate if the original retail consumer purchaser resells the Product or transfers the vehicle on which the Product is installed. An "original retail consumer purchaser" is a person who originally purchases the Product, or a gift recipient of a new Product that is in its original packaging and unopened.

This limited warranty is subject to all of the following terms and conditions:

TERMS AND CONDITIONS

1. NOTIFICATION OF CLAIMS; WARRANTY SERVICE: IF PURCHASER BELIEVES THAT A PRODUCT IS DEFECTIVE IN MATERIAL OR WORKMANSHIP, WRITTEN NOTICE WITH AN EXPLANATION OF THE CLAIM SHALL BE GIVEN PROMPTLY BY PURCHASER TO LEDGLOW. ALL WARRANTY CLAIMS MUST BE MADE WITHIN THE WARRANTY PERIOD, AND ANY PRODUCTS RETURNED TO LEDGLOW MUST BE SHIPPED IN ACCORDANCE WITH LEDGLOW'S PROCEDURES (INCLUDING USE OF RMA NUMBERS SUPPLIED BY LEDGLOW AFTER NOTIFICATION). THE REPAIR OR REPLACEMENT OF ANY PRODUCT OR PART THEREOF SHALL NOT EXTEND THE ORIGINAL WARRANTY PERIOD. THE SPECIFIC WARRANTY ON THE REPAIRED PART ONLY SHALL BE IN EFFECT FOR A PERIOD OF NINETY (90) DAYS FOLLOWING THE REPAIR OR REPLACEMENT OF THAT PART, OR THE REMAINING PERIOD OF THE PRODUCT WARRANTY, WHICHEVER IS GREATER.

2. EXCLUSIVE REMEDY; ACCEPTANCE: PURCHASER'S EXCLUSIVE REMEDY AND LEDGLOW'S SOLE OBLIGATION IS TO SUPPLY (OR PAY FOR) ALL LABOR NECESSARY TO REPAIR ANY PRODUCT FOUND TO BE DEFECTIVE WITHIN THE WARRANTY PERIOD AND TO SUPPLY NEW OR REBUILT REPLACEMENTS FOR DEFECTIVE PARTS. LEDGLOW WILL REFUND THE PURCHASE PRICE FOR SUCH PRODUCT ONLY IF REPAIR OR REPLACEMENT FAILS TO REMEDY THE DEFECT. PURCHASER'S FAILURE TO MAKE A CLAIM AS PROVIDED IN PARAGRAPH 1 ABOVE OR CONTINUED USE OF THE PRODUCT SHALL CONSTITUTE AN UNQUALIFIED ACCEPTANCE OF SUCH PRODUCT AND A WAIVER BY PURCHASER OF ALL CLAIMS THERETO.

3. EXCEPTIONS TO LIMITED WARRANTY: LEDGLOW SHALL HAVE NO OBLIGATION TO PURCHASER WITH RESPECT TO ANY PRODUCT THAT IS SUBJECT TO ANY OF THE FOLLOWING: ABUSE, IMPROPER USE, NEGLIGENCE, ACCIDENT, MODIFICATION, FAILURE TO FOLLOW THE OPERATING PROCEDURES OUTLINED IN THE USER'S MANUAL, FAILURE TO FOLLOW THE MAINTENANCE PROCEDURES IN THE SERVICE MANUAL FOR THE PRODUCT, ATTEMPTED REPAIR BY NON-QUALIFIED PERSONNEL, OPERATION OF THE PRODUCT OUTSIDE OF THE PUBLISHED ENVIRONMENTAL AND ELECTRICAL PARAMETERS, OR IF THE PRODUCT'S ORIGINAL IDENTIFICATION (TRADEMARK, SERIAL NUMBER) MARKINGS HAVE BEEN DEFACTED, ALTERED, OR REMOVED. LEDGLOW EXCLUDES FROM WARRANTY COVERAGE PRODUCTS SOLD AS IS AND/OR WITH ALL FAULTS. LEDGLOW ALSO EXCLUDES FROM WARRANTY COVERAGE ANY CONSUMABLE ITEMS SUCH AS FUSES AND BATTERIES.

All software and accompanying documentation furnished with, or as part of the Product is furnished "AS IS" (i.e., without any warranty of any kind), except where expressly provided otherwise in any documentation or license agreement furnished with the Product.

4. PROOF OF PURCHASE; REGISTRATION: The Purchaser's dated bill of sale must be retained as evidence of the date of purchase and to establish warranty eligibility. Registration of any Product or of this limited warranty is voluntary, and failure to register will not diminish any rights available under this warranty.

DISCLAIMER OF WARRANTY

EXCEPT FOR THE FOREGOING WARRANTIES, LEDGLOW HEREBY DISCLAIMS AND EXCLUDES ALL OTHER WARRANTIES, EXPRESS OR IMPLIED, INCLUDING, BUT NOT LIMITED TO ANY IMPLIED WARRANTIES OF MERCHANTABILITY, FITNESS FOR A PARTICULAR PURPOSE, OR ANY WARRANTY WITH REGARD TO ANY CLAIM OF INFRINGEMENT THAT MAY BE PROVIDED IN SECTION 2-312(3) OF THE UNIFORM COMMERCIAL CODE OR IN ANY OTHER STATE STATUTE.

LIMITATION OF LIABILITY

THE LIABILITY OF LEDGLOW, IF ANY, AND PURCHASER'S SOLE AND EXCLUSIVE REMEDY FOR DAMAGES FOR ANY CLAIM OF ANY KIND WHATSOEVER, REGARDLESS OF THE LEGAL THEORY AND WHETHER ARISING IN TORT OR CONTRACT, SHALL NOT BE GREATER THAN THE ACTUAL PURCHASE PRICE OF THE PRODUCT FOR WHICH SUCH CLAIM IS MADE. IN NO EVENT SHALL LEDGLOW BE LIABLE TO PURCHASER FOR ANY SPECIAL, INDIRECT, INCIDENTAL, OR CONSEQUENTIAL DAMAGES OF ANY KIND INCLUDING, BUT NOT LIMITED TO, COMPENSATION, REIMBURSEMENT OR DAMAGES ON ACCOUNT OF THE LOSS OF PRESENT OR PROSPECTIVE PROFITS OR FOR ANY OTHER REASON WHATSOEVER.

GOVERNING LAW: This non-transferrable limited warranty shall be governed by the law of the State of New Jersey, U.S.A., and the United States of America, excluding their conflicts of laws principles. The courts of Camden County, New Jersey, shall have the exclusive jurisdiction over any legal action with respect to this warranty.

This limited warranty gives specific legal rights. You may also have other rights that may vary from state to state or from country to country. Some states or countries do not allow the exclusion or limitation of incidental or consequential damages, so the above limitations and exclusions may not apply to you. You are advised to consult applicable state or country laws for a full determination of rights.